

Location: Harbin, China

Initiated: 1907

Completed: 1932

Max Height: 53.35m

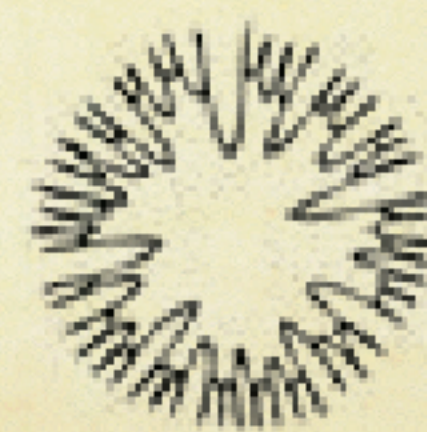
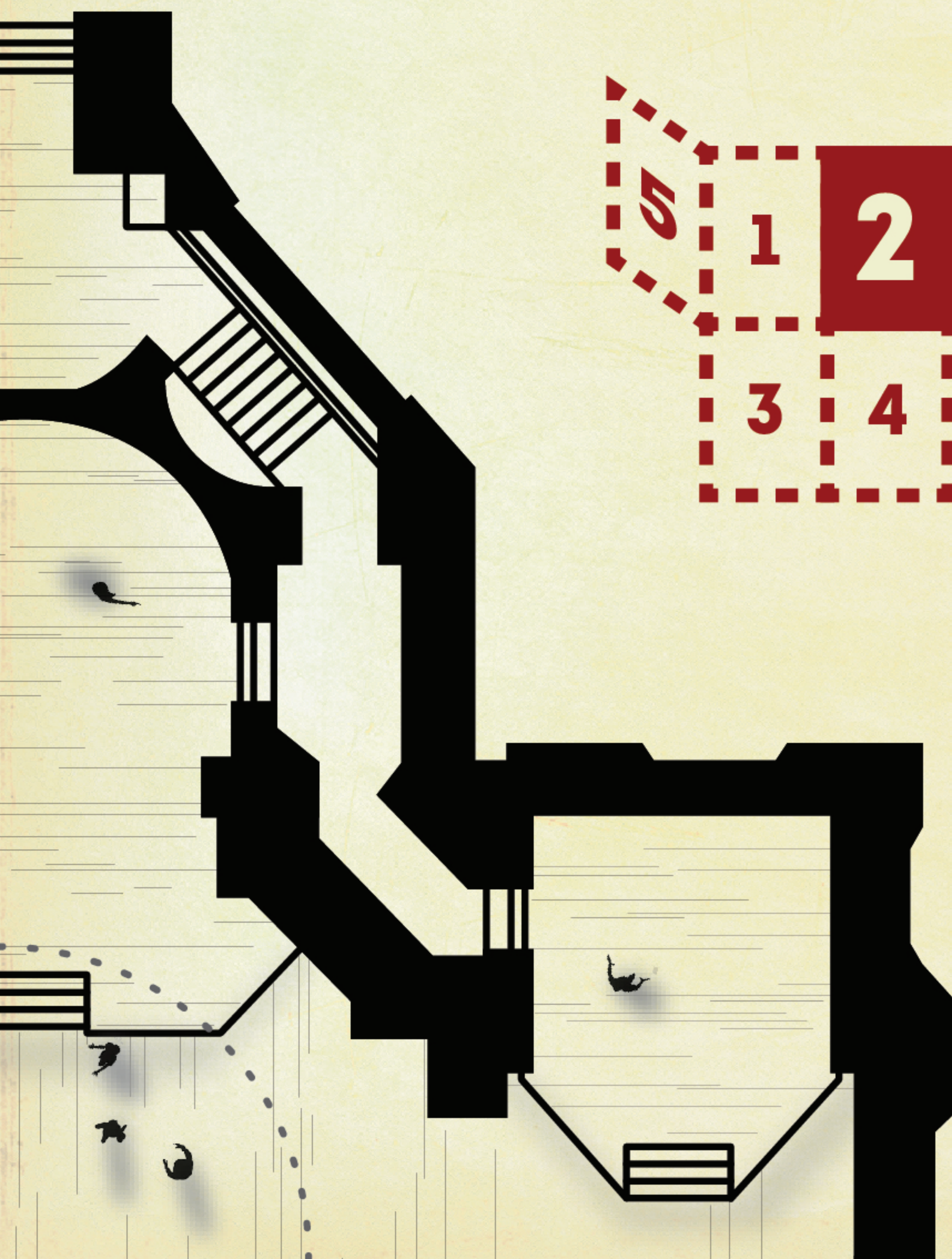

Post Card



AR Mail From Harbin

HA2.0

1. Download a QR code reader of your choice on your mobile device
2. Using the QR code reader, scan this QR code to download the app, "AR Mail From Harbin"
3. View the drawing on the back side using the app, "AR Mail From Harbin"

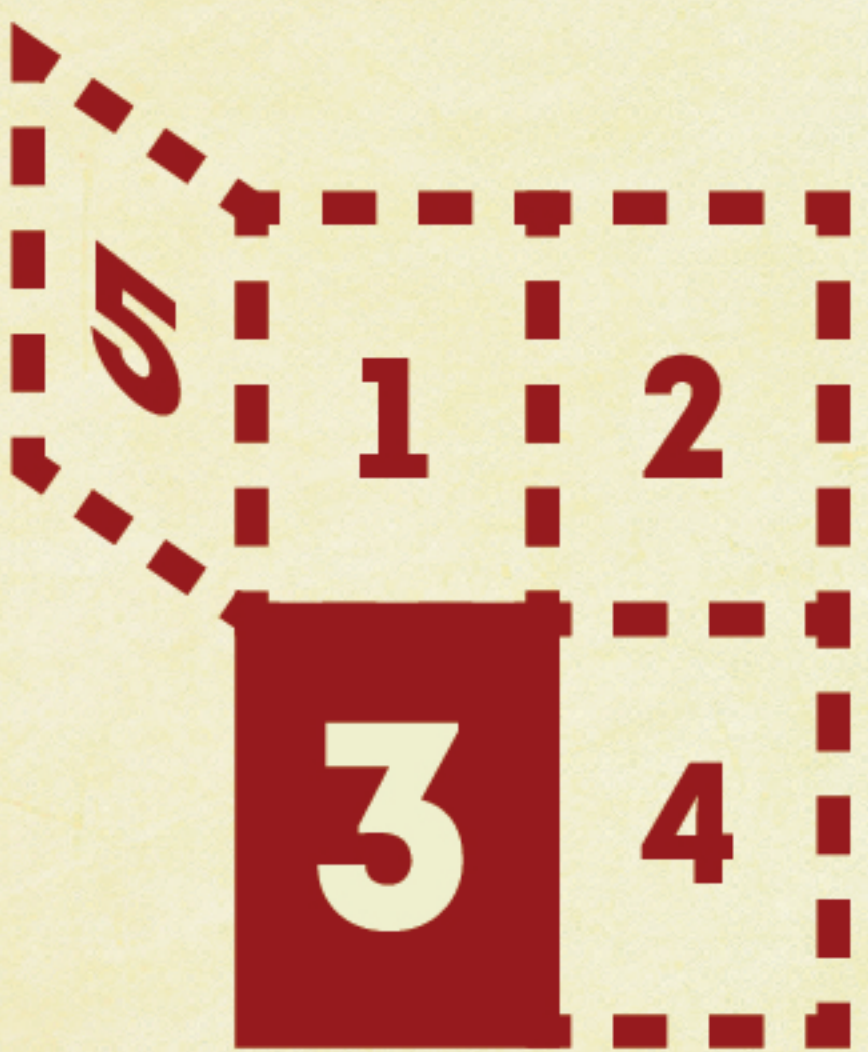
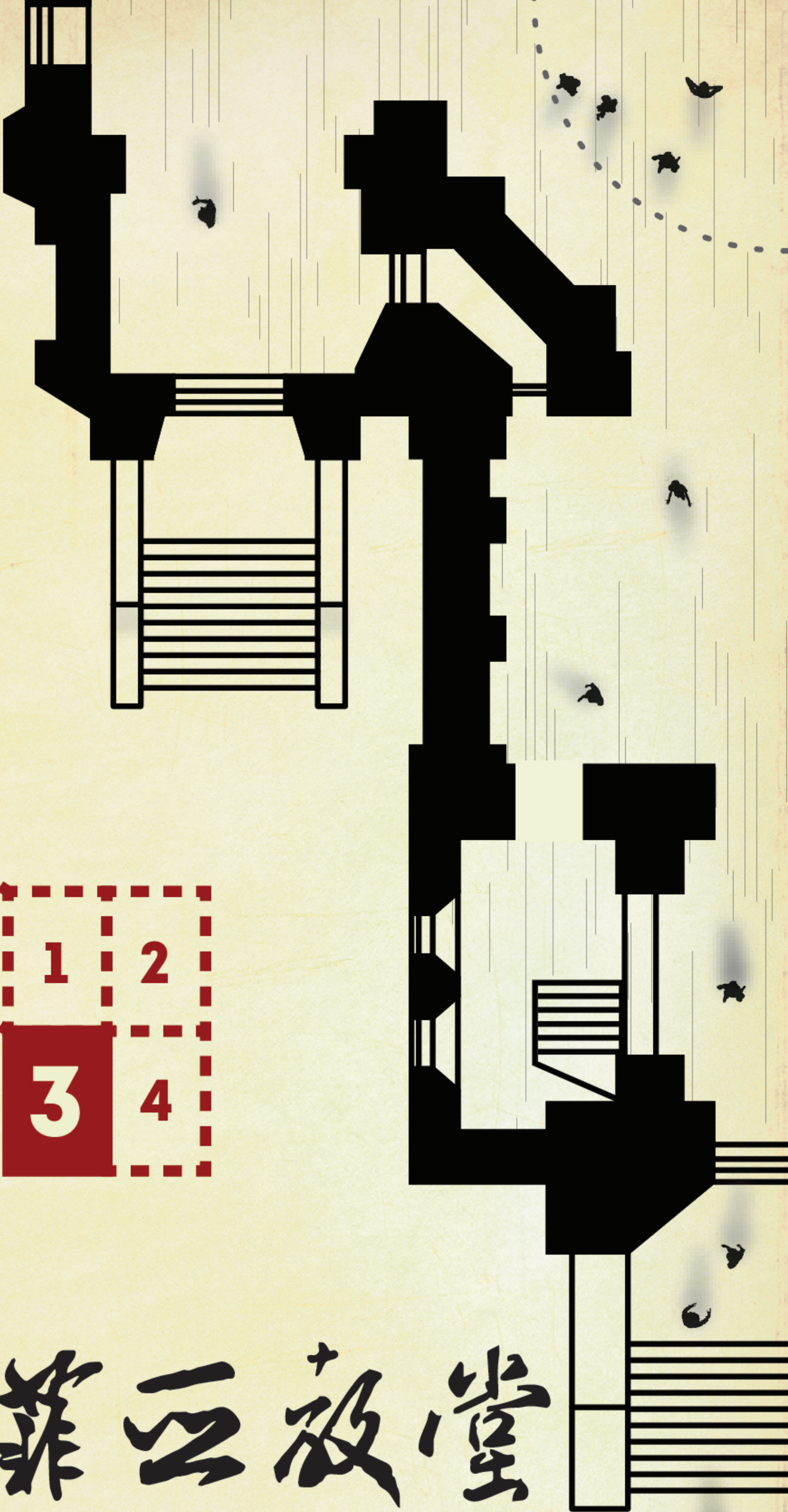

聖索菲亞教堂

AR Mail from Harbin: Takehiko Nagakura + Woongki Sung + Dan Li, in collaboration with
Harbin Institute of Technology + Harbin St. Sophia Cathedral + MIT-SUTD, IDC Research Program

Post Card



AR Mail From Harbin

HA2.0

1. Download a QR code reader of your choice on your mobile device
2. Using the QR code reader, scan this QR code to download the app, "AR Mail From Harbin"
3. View the drawing on the back side using the app, "AR Mail From Harbin"

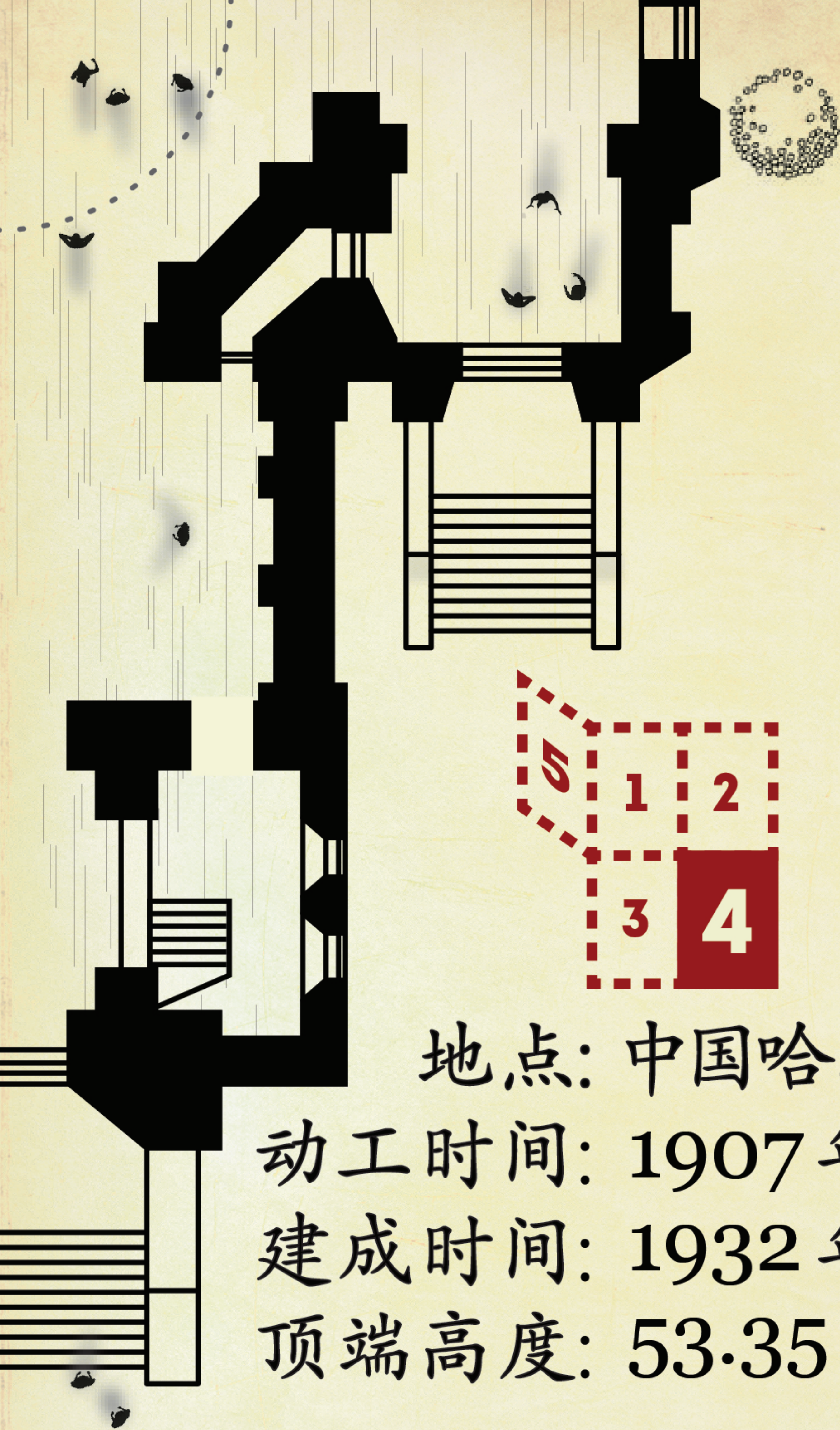

地点：中国哈尔滨
动工时间：1907年
建成时间：1932年
顶端高度：53.35米

Post Card



AR Mail From Harbin

HA2.0

1. Download a QR code reader of your choice on your mobile device
2. Using the QR code reader, scan this QR code to download the app, "AR Mail From Harbin"
3. View the drawing on the back side using the app, "AR Mail From Harbin"



AR MAIL FROM HARBIN

Post Card



AR Mail From Harbin HA2.0

1. Download a QR code reader of your choice on your mobile device
2. Using the QR code reader, scan this QR code to download the app, "AR Mail From Harbin"
3. View the drawing on the back side using the app, "AR Mail From Harbin"

AR MAIL FROM HARBIN

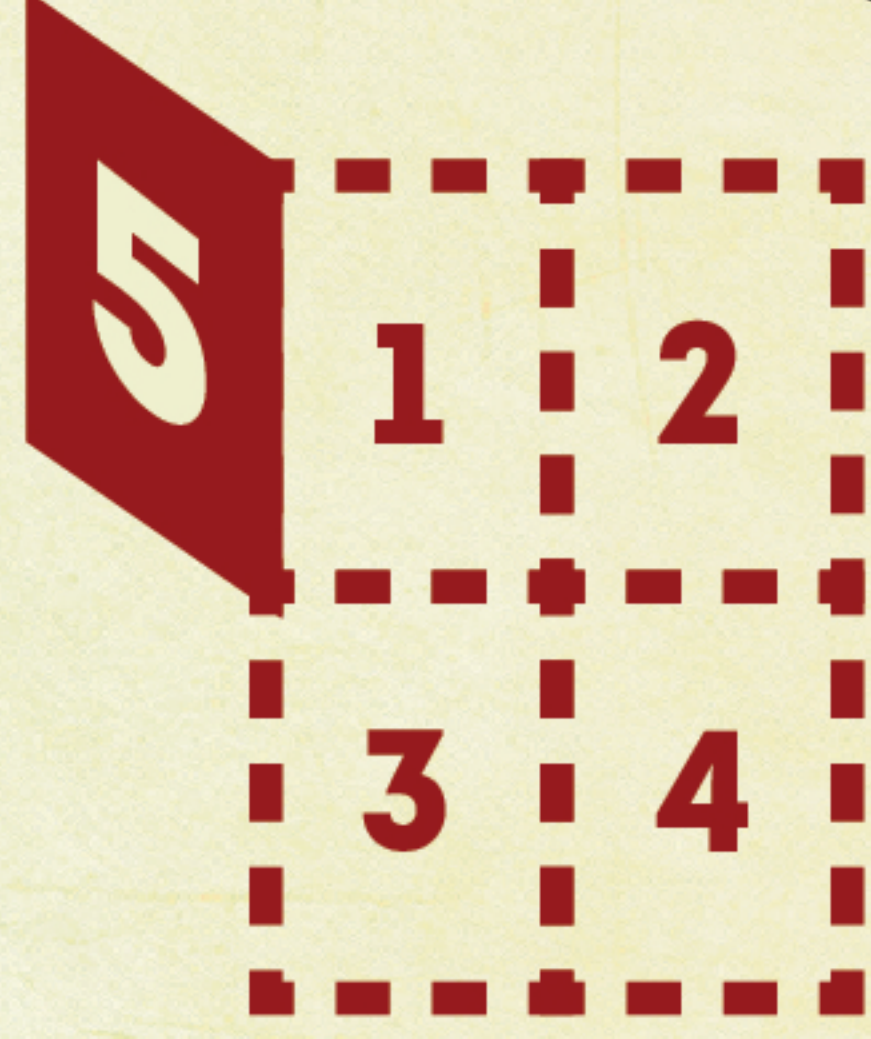

AR Mail from Harbin: Takehiko Nagakura + Woongki Sung + Dan Li, in collaboration with Harbin Institute of Technology + Harbin St. Sophia Cathedral + MIT-SUTD, IDC Research Program

Saint Sophia

The Cathedral of the Holy Wisdom of God

AR Mail from Harbin: Takehiko Nagakura + Woongki Sung + Dan Li, in collaboration with Harbin Institute of Technology + Harbin St. Sophia Cathedral + MIT-SUTD, IDC Research Program

